

CODE: **AWO384** v.1.0/III  
 NAME: **PS/RS 2 Enclosure**

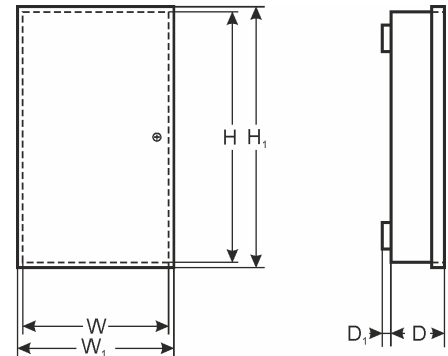

EXAMPLE OF ASSEMBLY:

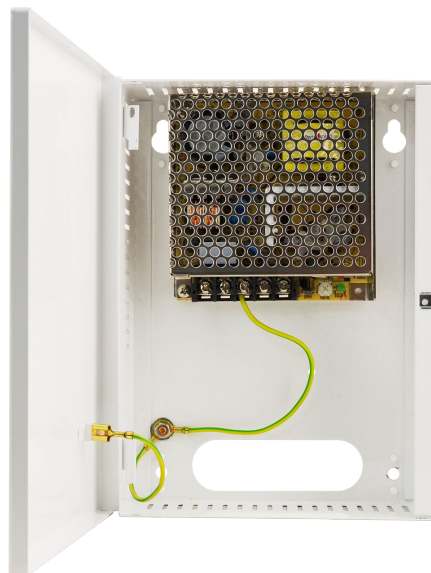

### DESTINATION

**AWO384** enclosure is designed for mounting built-in power supplies of the following series:

**LRS-35-xx, LRS-50-xx, LRS-75-xx, LRS-100-xx, LRS-150-xx.**

**RS-15-xx, RS-25-xx, RS-35-xx, RS-50-xx, RS-75-xx, RS100-xx.**

**PS-15xxxx, PS-25xxxx, PS-40xxxx, PS-60xxxx.**

The enclosure is made of steel with a thickness of 0.7 mm, in white color RAL9003

### TECHNICAL DATA

External dimensions of the enclosure:  $W=148, H=203, D+D_1=52+8$  [± 2mm]

External dimensions of the front panel:  $W_1=152, H_1=208$  [± 2mm]

Weight net/gross: 0,62kg / 0,70kg [± 0,1kg]

Material description: sheet steel DC01, thickness: 0,7mm, protection anticorrosion, color: RAL 9003

Destination: indoor

Closing: screwed: screw x 1

Notes: the enclosure includes a set of M3x4 screws – 2 pieces,  
distance from the wall 8mm

Declarations, warranty: CE, RoHS, 2 year from the production date